

Fitting Instructions Bracket Panthera U2 Light / U3 Light art.nr: 30037

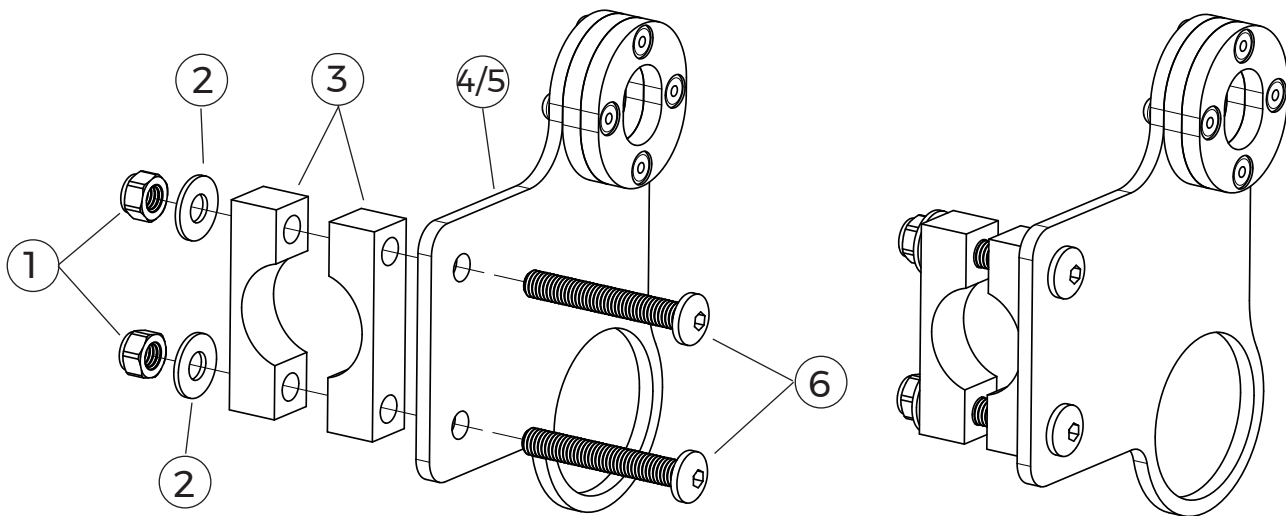

Part list			
Pos.	Art. nr.	Description	Remark/Qty
1	50101	M5 Lock Nut	4
2	50062	Washer M5 FZB	4
3	50044	Clamp Panthera	4
4	30007	Bracket U2 Light U3 Light Right	1
5	30008	Bracket U2 Light U3 Light Left	1
6	50115	M5x40 T25 Black	4

Fitting Instructions Bracket

Panthera U2 Light / U3 Light

art.nr. 30037

Tools needed

Hex key 3 mm
Socket wrench 8 mm

Check that all parts are included

See part list

Mounting

- All parts mounted, Pic 1.
- Brackets mounted on the left side. Pic 2.
- Mount the screw in the bracket and first clamp.
- Mount the bracket on the wheelchair according to pic 2.
- Mount the other clamp, washers and lock nuts on the screws. Tighten it with Hex Key 3 mm and Socket wrench 8 mm. Pic. 3.
- Make sure that the lock nuts are tightened so the bracket can't be moved.
- Make sure that the spike of the wheels fits in to the bracket according to pic 4.
- Video is available at www.gearwheel.se.



Pic 1: Bracket.



pic 2: Bracket mounted.

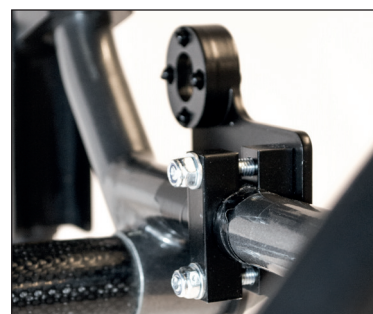

Pic 3: Mounted bracket from the inside.

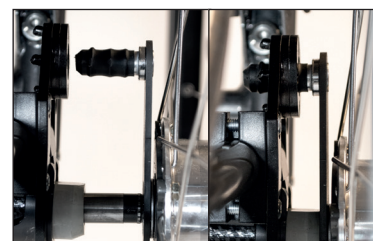

Pic 4; Fitting the spike on the wheel.